

BOSS spare parts & accessories - for water

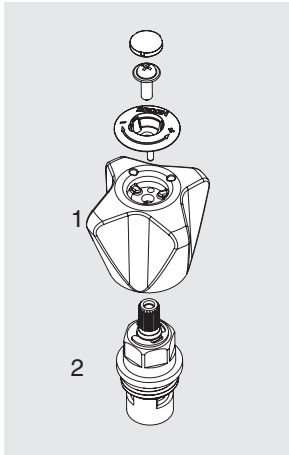

No. 19 850.009

Complete 1/2" ceramic head work.

Opening/closing function = 180°.

- 1 No. 19 167.01G handle
- 2 No. 19 760.00 head work

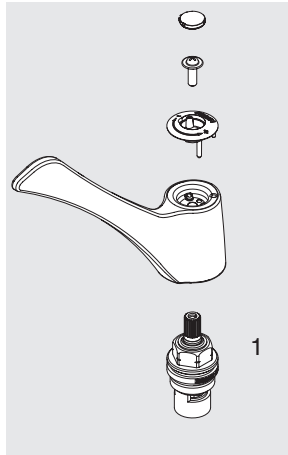

No. 19 164.299 (right turn closing)

Complete 1/2" wrist action handle with ceramic head work (cold water).

Opening/closing function = 90°.

- 1 No. 19 763.000



19 164.289 (left turn closing)

Complete 1/2" wrist action handle with ceramic head work (hot water).

Opening/closing function = 90°.

- 1 No. 19 763.000

BROEN offers a wide range of replacement parts and accessories to compliment our range of BOSS laboratory fittings.

These parts are constructed with the same attention to quality as the original parts and will have long life and superior performance.

BOSS spare parts & accessories - for water

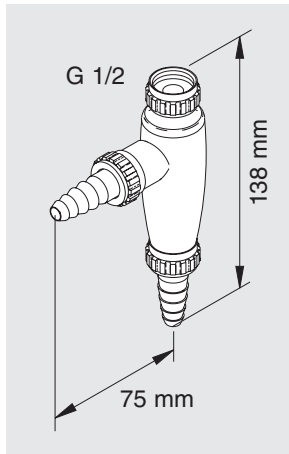

No. 19 198.009

Vacuum pump with built-in non-return valve and G 1/2 detachable union nut.

Materials with contact to vacuum:

Brass Din 17660
Cu-Zn39Pb3
Sealing *Viton®
Check valve POM, PP, silicone

Materials with contact to water:

Brass Din 17660
Cu-Zn39Pb3
Sealing EPDM
Glue Loctite

For further information please require our data sheet concerning vacuum pumps.

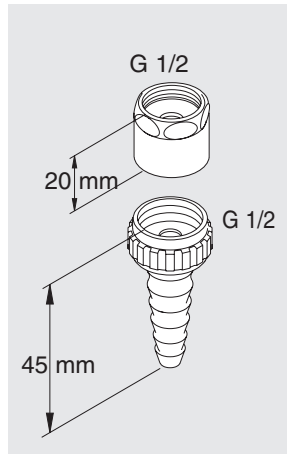

No. 19 025.009

Aerator with G 1/2" connection.

No. 19 229.009

Nozzle with detachable union nut.

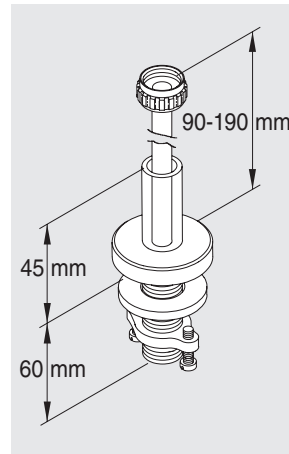

No. 19 232.009

Lead-in for vacuum pump.

All water fittings are delivered with a detachable nozzle with a loose union nut, which leads to a fast and unproblematic mounting and deounting of same even when a hose has been fixed to the nozzle.

Please note: If a nozzle is not being used, an aerator ought to be fixed to the spout.

BOSS spare parts & accessories - for water

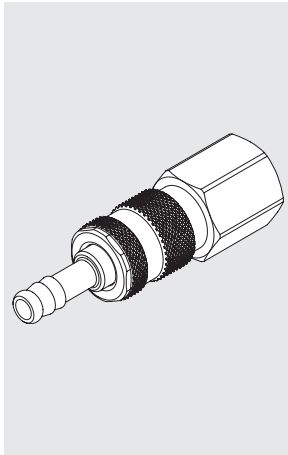

No. 19 631.003
Quick-release coupling for water.

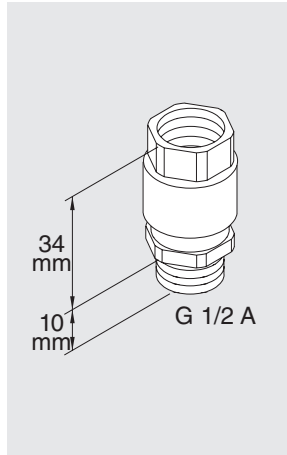

No. 19 484.109
In-line vacuum breaker.

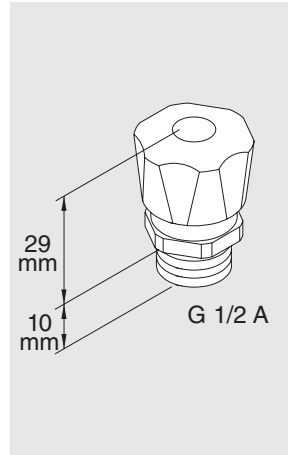

No. 19 233.109
End-line vacuum breaker.

All BROEN accessories can be easily adapted to existing fittings.

BOSS spare parts & accessories

- for water

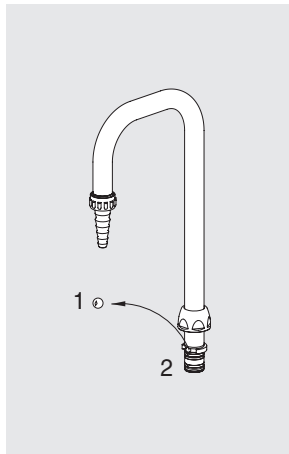

Spare parts for swivel spouts

- 1 No. 09 701.04 plastic ring
- 2 No. 96C0012 ball
- 3 No. 92A0012 o-ring x 2

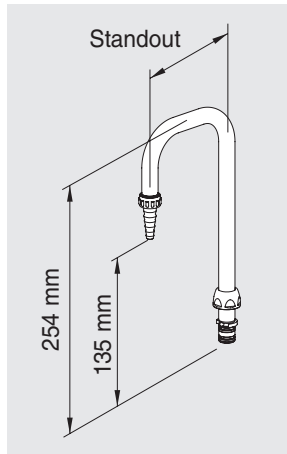

Spout for bench fittings

- No. 09 814.129 Standout 120 mm
- No. 09 814.159 Standout 150 mm
- No. 09 814.189 Standout 180 mm
- No. 09 814.239 Standout 230 mm

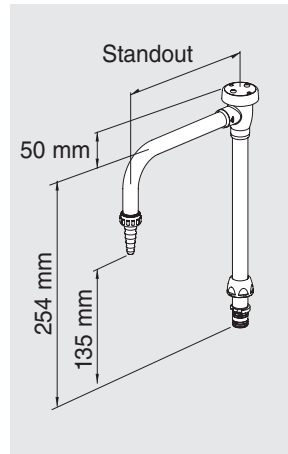

Spout for bench fittings with vacuum breaker.

- No. 09 824.129 Standout 120 mm
- No. 09 824.159 Standout 150 mm
- No. 09 824.189 Standout 180 mm
- No. 09 824.239 Standout 230 mm

Like above, but with aerator:

- No. 09 914.129 Standout 120 mm
- No. 09 914.159 Standout 150 mm
- No. 09 914.189 Standout 180 mm
- No. 09 914.239 Standout 230 mm

BROEN swivel spouts are prepared for 3 different field adjustable settings;

- fixed
- limited swivel action
- full swivel

To avoid damage of the fitting coating it is recommended to use key# 19 502.00 for fastening of swivel spout.

BOSS spare parts & accessories - for water

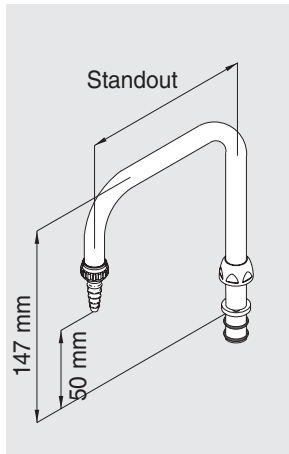

Spout for mixer

No. 09 819.209
Standout 200 mm

Like above, but with aerator:

No. 09 919.209
Standout 200 mm

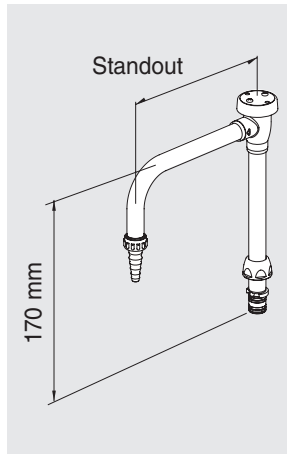

Spout for mixer with
vacuum breaker.

No. 09 822.189
Standout 180 mm

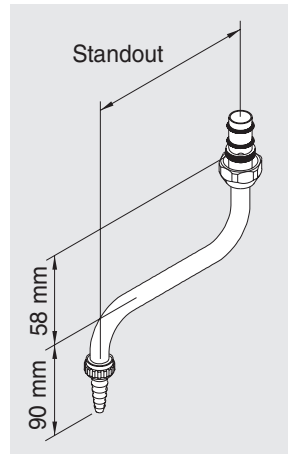

Spout for mixer

No. 09 831.209
Standout 200 mm

Like above, but with aerator:

No. 09 931.209
Standout 200 mm

BROEN swivel spouts are prepared for 3 different field adjustable settings;

- fixed
- limited swivel action
- full swivel

To avoid damage of the fitting coating it is recommended to use key# 19 502.00 for fastening of swivel spout.

BOSS spare parts & accessories

- for gases and vacuum

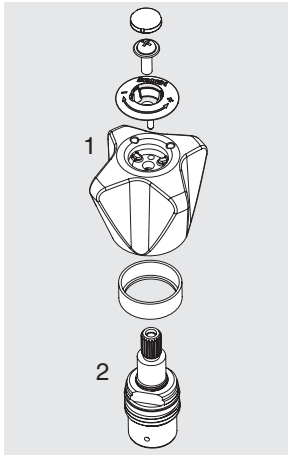

No. 02 557.350

Complete head work
(1/2") incl. handle for
non-burning 2.0 gases.
(Green indication ring).

1 No. 19 167.01G
handle

2 No. 02 557.300
core head work

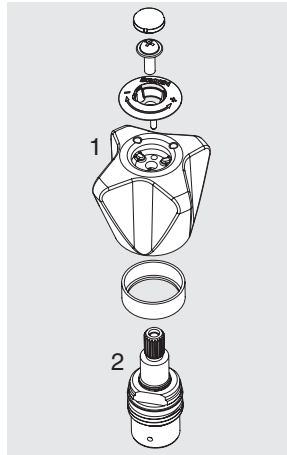

No. 02 556.350

Complete head work
(1/2") incl. handle for
high flow and vacuum.
(Grey indication ring).

1 No. 19 167.01G
handle

2 No. 02 556.300
core head work

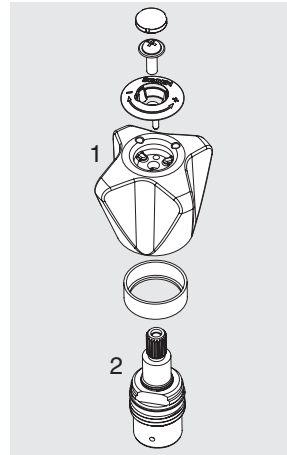

No. 02 559.350

Complete head work
(1/2") incl. handle for
non-burning 4.0 gases.
(Blue indication ring).

1 No. 19 167.01G
handle

2 No. 02 559.300
core head work

BROEN offers a wide range of replacement parts and accessories to compliment our range of BOSS laboratory fittings.

These parts are constructed with the same attention to quality as the original parts and will have long life and superior performance.

BOSS spare parts & accessories

- for burning gases

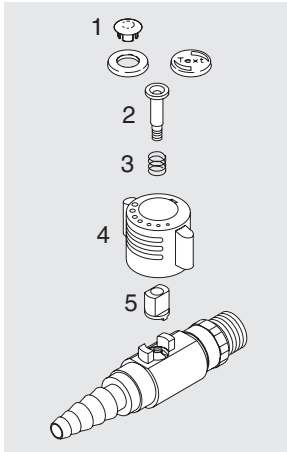

School gas valve.

- 1 No. 01 396.08 + text
- 2 No. 01 396.07 screw
- 3 No. 15 292.11 spring
- 4 No. 01 396.19 handle
- 5 No. 01 396.06 carrier

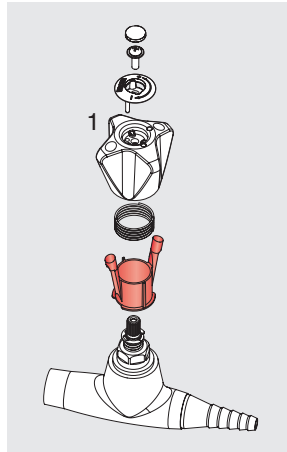

BOSS gas valve.
Head work is glued into the valve housing and must not be replaced.

- 1 No. 19 193.009 handle

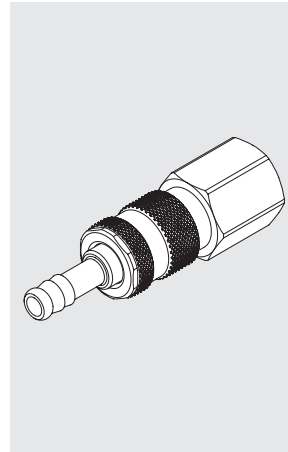

Quick-release coupling for gas.

- No. 19 641.003
G 1/2" connection.

BROEN offers a wide range of replacement parts and accessories to compliment our range of BOSS laboratory fittings.

These parts are constructed with the same attention to quality as the original parts and will have long life and superior performance.

A special "pop-up" indication handle can be delivered making it possible visually to observe if the valve is open.

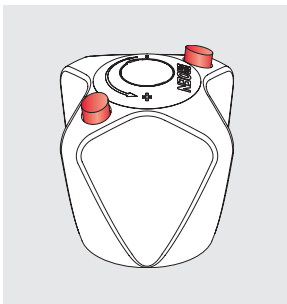

As illustrated, two buttons (red) will "pop-up" when the valve is in the open position.

BOSS spare parts & accessories

- for non-burning gases

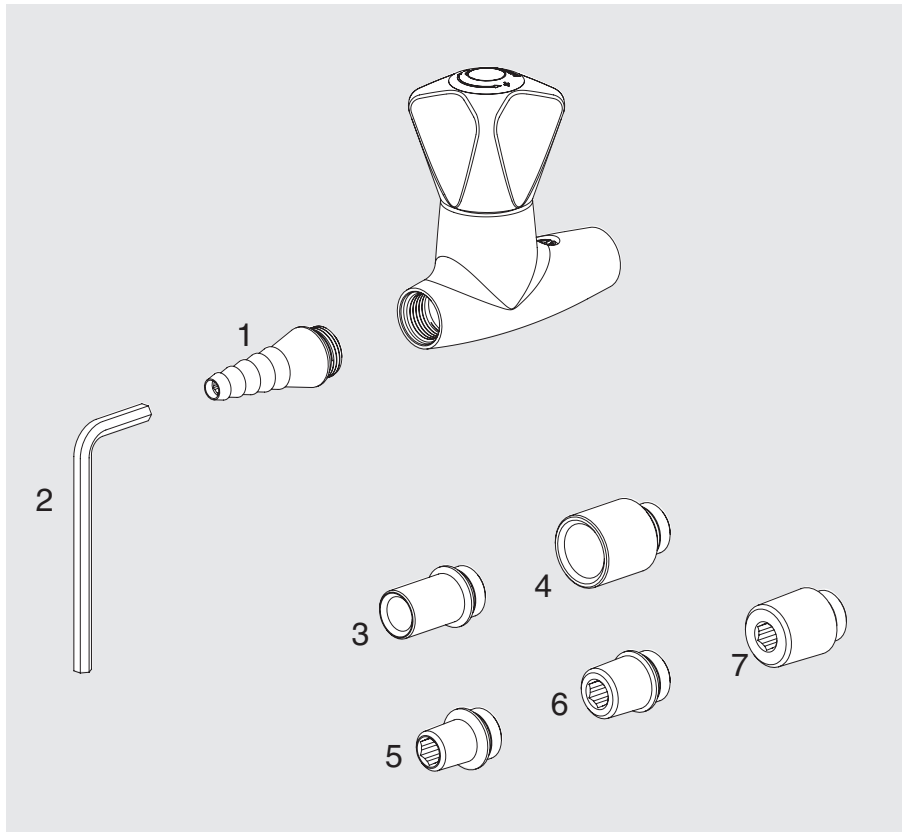

BOSS fittings for non-burning gases are delivered with a serrated nozzle, detachable with key No. 96K0002. This enables the mounting of other outlet adaptors.

- | | |
|---|--|
| 1 | No. 19 451.109 nozzle |
| 2 | No. 96K0002 key |
| 3 | No. 19 452.102 outlet nipple G3/8A x G1/2A |
| 4 | No. 19 460.009 outlet socket G3/8A x G1/2 |
| 5 | No. 19 461.003 outlet nipple G3/8A x G3/8A |
| 6 | No. 19 462.003 outlet nipple G3/8A x G1/4A |
| 7 | No. 19 463.009 outlet socket G3/8A x G1/4 |

BOSS spare parts & accessories

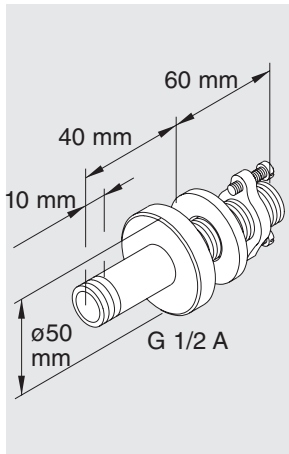

No. 19 413.009
Lead-in with flange.

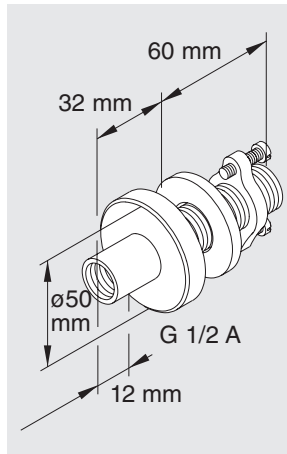

No. 18 626.009
Lead-in with flange.

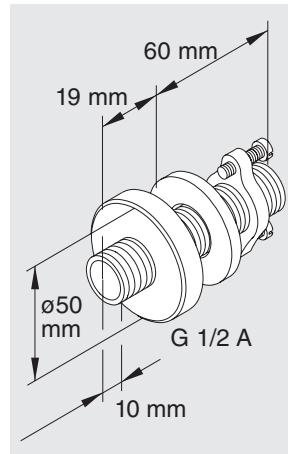

No. 19 064.009
Lead-in with flange.

Lead-in with flange.

No. 19 291.009
Lead-in with flange,
but with G 3/8 A
outlet nipple.

No. 19 034.009
Lead-in with flange,
but with G 3/8 A
outlet nipple.

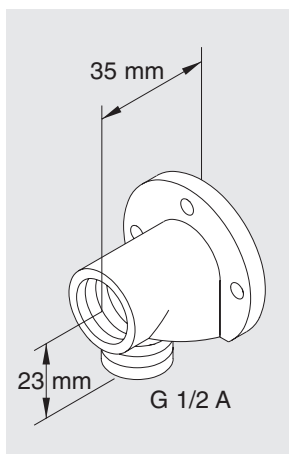

No. 19 406.009
Angle wall section
with flange.

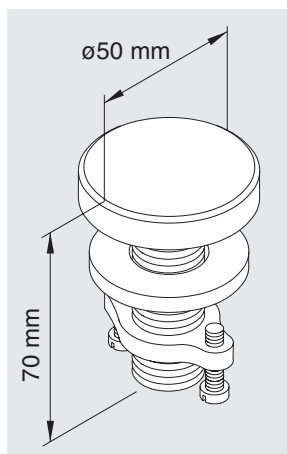

No. 19 640.009
Blank-off cover.

BOSS spare parts & accessories

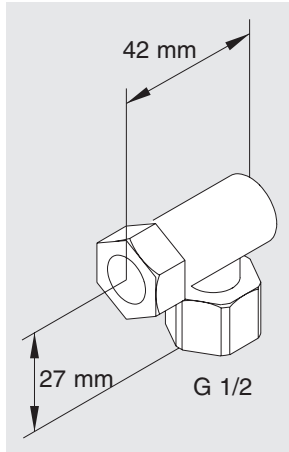

No. 18 727.00

Angular coupling with union nut and ompression coupling for $\varnothing 10$ mm copper pipe.

Delivered in raw brass.

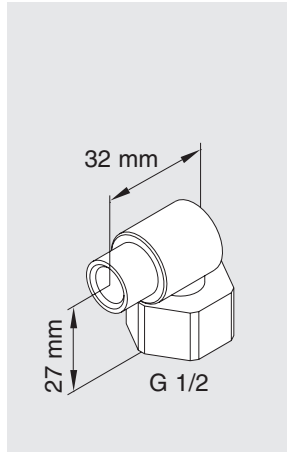

No. 18 728.00

Angular coupling with union nut for brazing connection to $\varnothing 10$ mm copper pipe.

Delivered in raw brass.

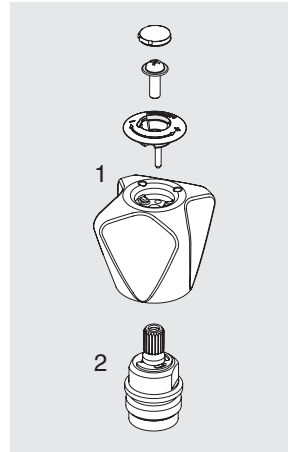

No. 19 152.459

Complete head work for fittings for special water sorts.

1 No. 19 167.129
Handle

2 No. 19 152.400
Head work

Angle coupling for front loaded fume hood fittings with copper tubing and ON/OFF discs.

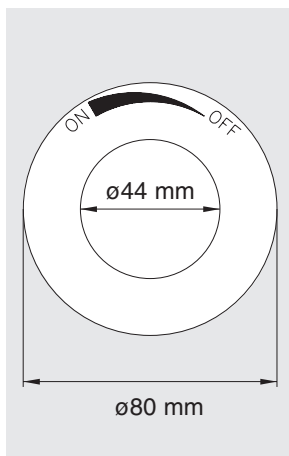

No. 19 485.00

ON-OFF disc for front-control valves with M40 thread.

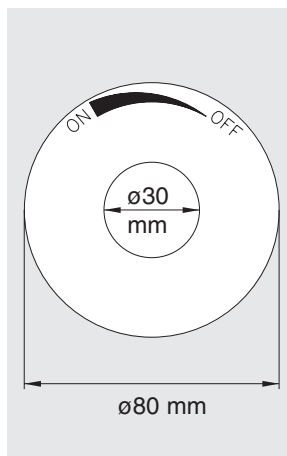

No. 19 488.00

ON-OFF disc for front-control valves with M28 thread.