

**BROEN**

*for the Professional user*

# BROEN school fittings

- for burning gases

## contents

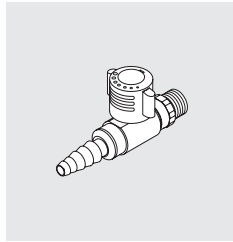

05-2

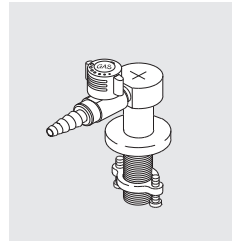

05-3

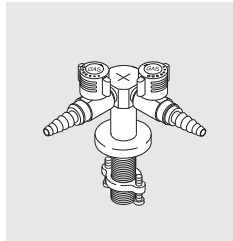

05-4

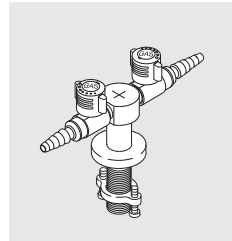

05-5

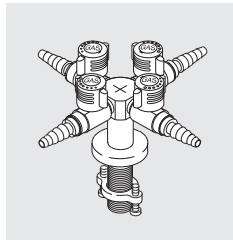

05-6

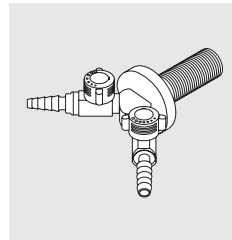

05-7

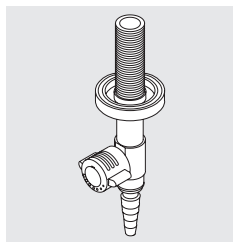

05-8

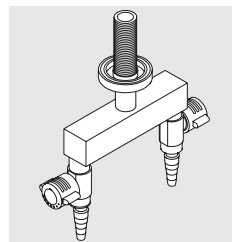

05-9

## BROEN school fittings

### - for burning gases

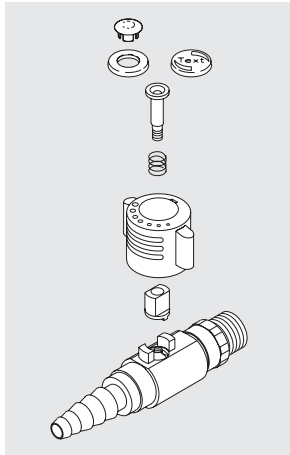

BROEN school fittings for burning gases with "lift/turn" safety handles.

The valves are based on a BALLOFIX ball valve.

Opening/closing function 90° turn.

Spare parts see section 13.

#### Materials with medium contact:

Metals	Brass and nickel
Sealing	Nitrile
Lubricant	Approved for burning gas
Glue	Loctite

#### Flow chart

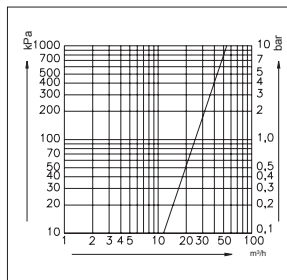

**BROEN school fittings for burning gases can be used for natural, town and low pressure bottle gases as well as vacuum and compressed air.**

The school fittings are designed to be used where a small and simple gas valve in large quantities is requested.

However, the BROEN school fittings are delivered with many safety features, all handles are e.g. mounted with "lift/turn" safety system.

Maximum working pressure is 7 bar/100 PSI.

Every school fitting is leak tested before leaving our factory.

Allowable pressure test after installation:

1.5 x max. working pressure without function of the valve.

## BROEN school fittings - for burning gases

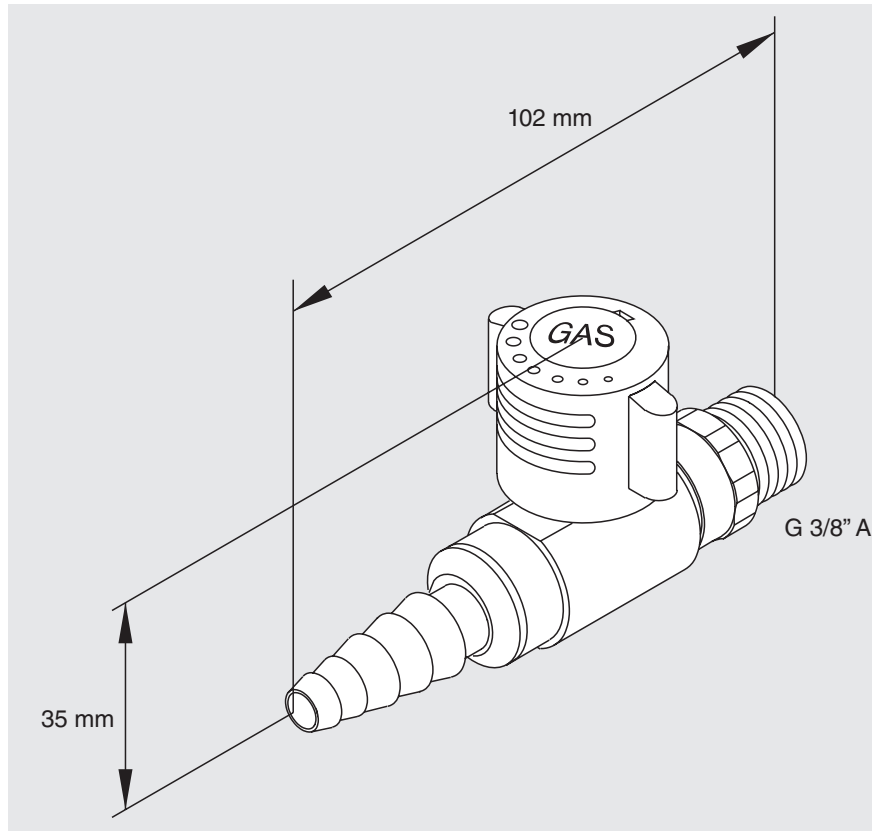

**BROEN school fittings for burning gases can be used for natural, town and low pressure bottle gases as well as vacuum and compressed air.**

The valves are designed to be used where a small and simple gas valve in large quantities is required.

BROEN school fittings have several safety features, including "lift/turn" safety handles and vandal resistant mounting accessories.

The fittings are surface treated with BROEN POLYCOAT powder coat, which is highly resistant to most chemicals, UV fading and heat.

**No. 08 317.019** School valve with a "lift/turn" safety handle.

#### Materials with medium contact:

Metals:	Brass and nickel
Sealing:	Nitrile
Lubricant:	Approved for burning gas
Glue:	Loctite

Weight: 0.1 kg

Maximum working pressure:  
7 bar/100 psi.

## BROEN school fittings - for burning gases

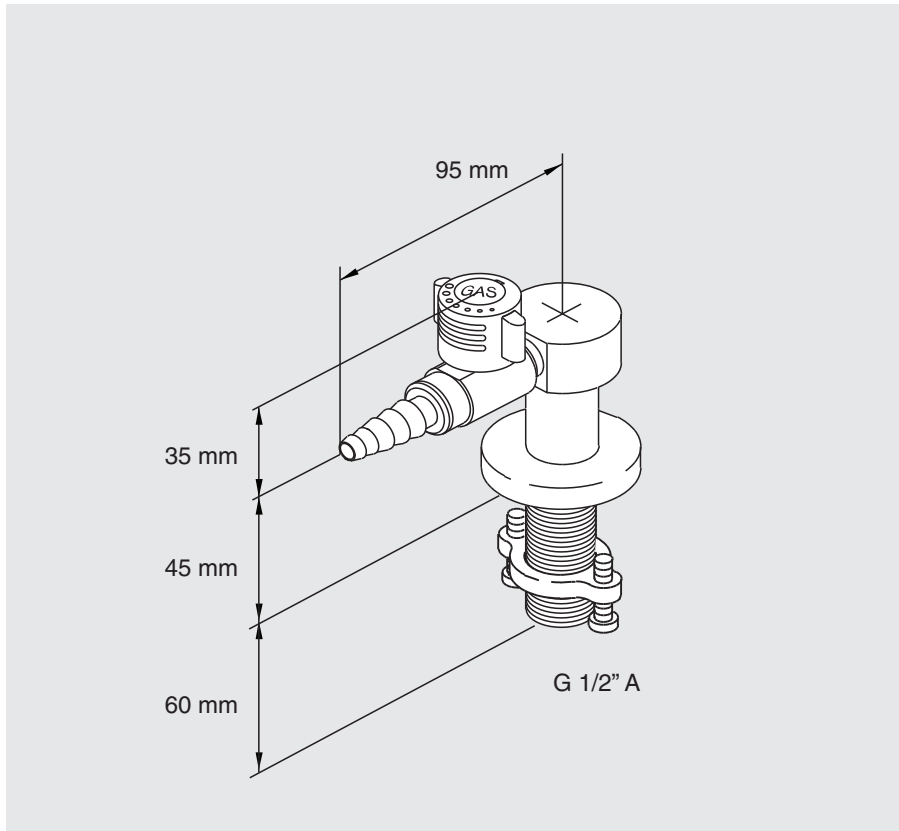

**BROEN school fittings for burning gases can be used for natural, town and low pressure bottlegases as well as vacuum and compressed air.**

The valves are designed to be used where a small and simple gas valve in large quantities is required.

BROEN school fittings have several safety features, including "lift/turn" safety handles and vandal resistant mounting accessories.

The fittings are surface treated with BROEN POLYCOAT powder coat, which is highly resistant to most chemicals, UV fading and heat.

**No. 08 317.989** Bench mounted school fitting with 1 valve and a "lift/turn" safety handle.

Delivered with mounting accessories.

### Materials with medium contact:

Metals:	Brass and nickel
Sealing:	Nitrile
Lubricant:	Approved for burning gas
Glue:	Loctite

Weight: 0.7 kg

Maximum working pressure:  
7 bar/100 psi.

### Mounting information:

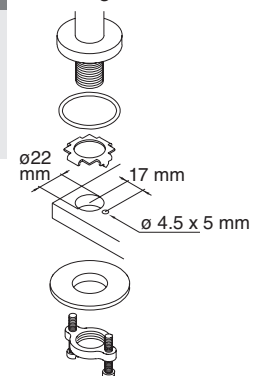

Drill  $\varnothing$  22 mm for the inlet.  
Drill  $\varnothing$  4.5 mm for the locking ring at a distance of 17 mm from the center of the  $\varnothing$  22 mm hole.  
The  $\varnothing$  4.5 mm hole must be at least 5 mm deep.

## BROEN school fittings - for burning gases

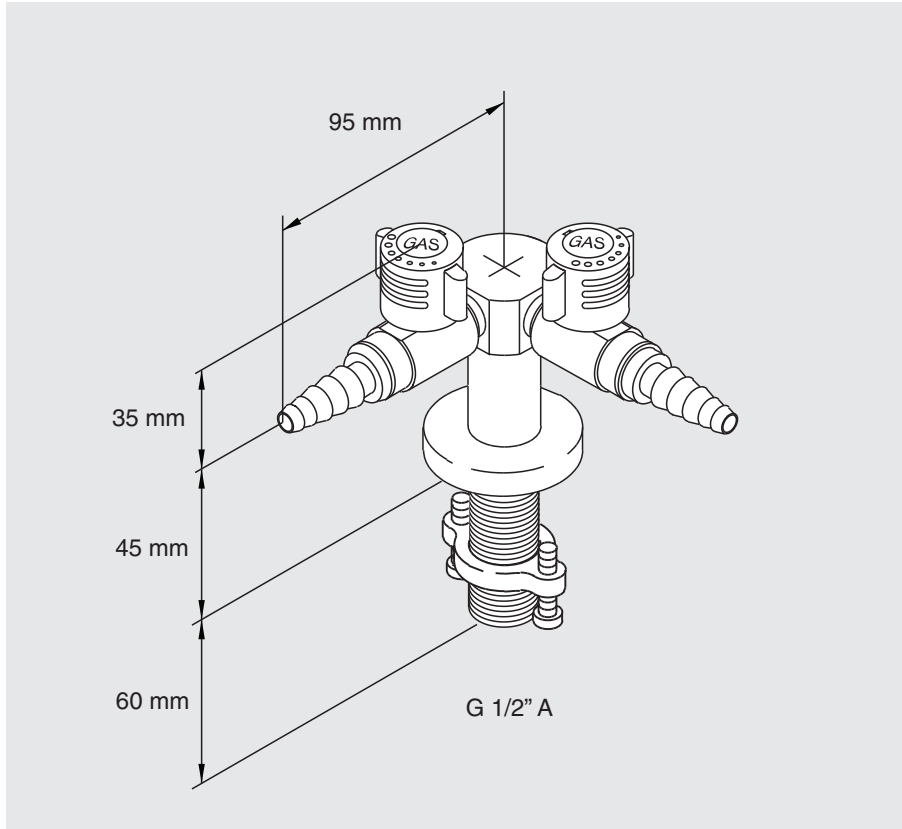

**BROEN school fittings for burning gases can be used for natural, town and low pressure bottlegases as well as vacuum and compressed air.**

The valves are designed to be used where a small and simple gas valve in large quantities is required.

BROEN school fittings have several safety features, including "lift/turn" safety handles and vandal resistant mounting accessories.

The fittings are surface treated with BROEN POLYCOAT powder coat, which is highly resistant to most chemicals, UV fading and heat.

**No. 08 318.989** Bench mounted school fitting with 2 valves (90°) and "lift/turn" safety handles.

Delivered with mounting accessories.

### Materials with medium contact:

Metals:	Brass and nickel
Sealing:	Nitrile
Lubricant:	Approved for burning gas
Glue:	Loctite

Weight: 0.8 kg

Maximum working pressure:  
7 bar/100 psi.

### Mounting information:

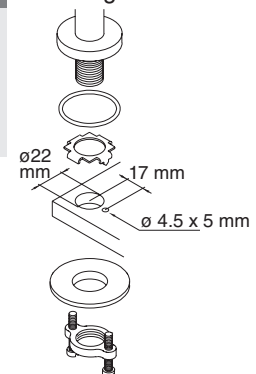

Drill  $\varnothing$  22 mm for the inlet.  
Drill  $\varnothing$  4.5 mm for the locking ring at a distance of 17 mm from the center of the  $\varnothing$  22 mm hole.  
The  $\varnothing$  4.5 mm hole must be at least 5 mm deep.

## BROEN school fittings

### - for burning gases

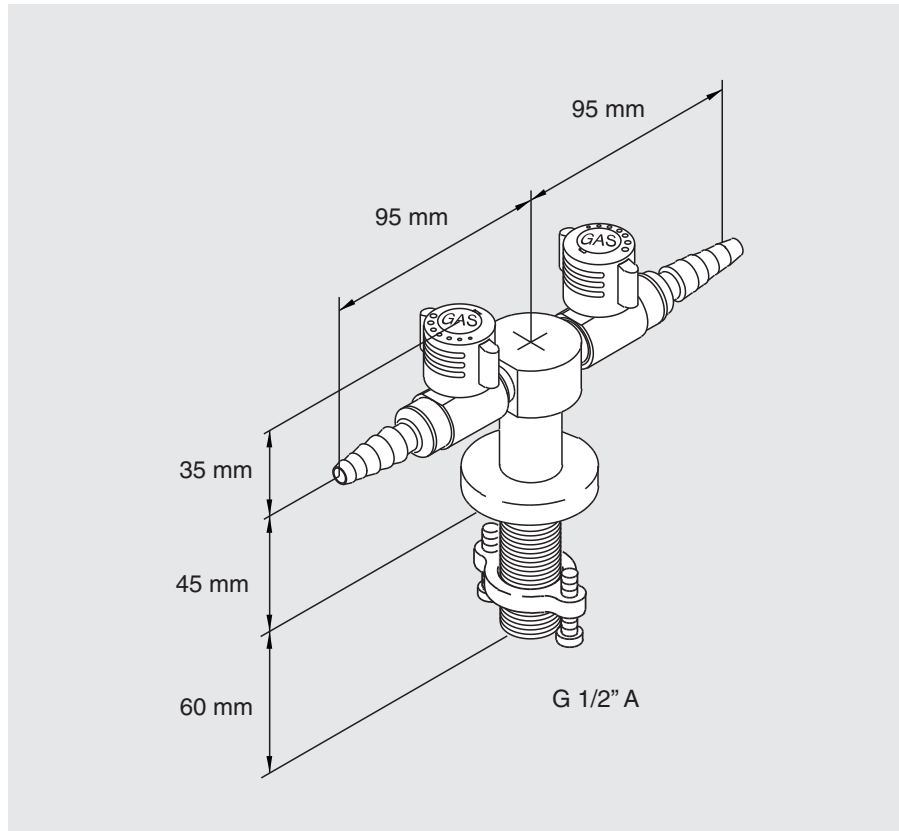

**BROEN school fittings for burning gases can be used for natural, town and low pressure bottle gases as well as vacuum and compressed air.**

The valves are designed to be used where a small and simple gas valve in large quantities is required.

BROEN school fittings have several safety features, including "lift/turn" safety handles and vandal resistant mounting accessories.

The fittings are surface treated with BROEN POLYCOAT powder coat, which is highly resistant to most chemicals, UV fading and heat.

**No. 08 319.989** Bench mounted school fitting with 2 valves (180°) and "lift/turn" safety handles.

Delivered with mounting accessories.

#### Materials with medium contact:

Metals	Brass and nickel
Sealing	Nitrile
Lubricant	Approved for burning gas
Glue	Loctite

Weight: 0.8 kg

Maximum working pressure:  
7 bar/100 psi.

#### Mounting information:

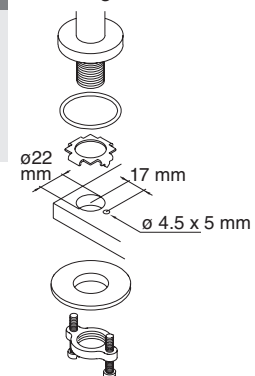

Drill  $\varnothing$  22 mm for the inlet.  
Drill  $\varnothing$  4.5 mm for the locking ring at a distance of 17 mm from the center of the  $\varnothing$  22 mm hole.  
The  $\varnothing$  4.5 mm hole must be at least 5 mm deep.

## BROEN school fittings

### - for burning gases

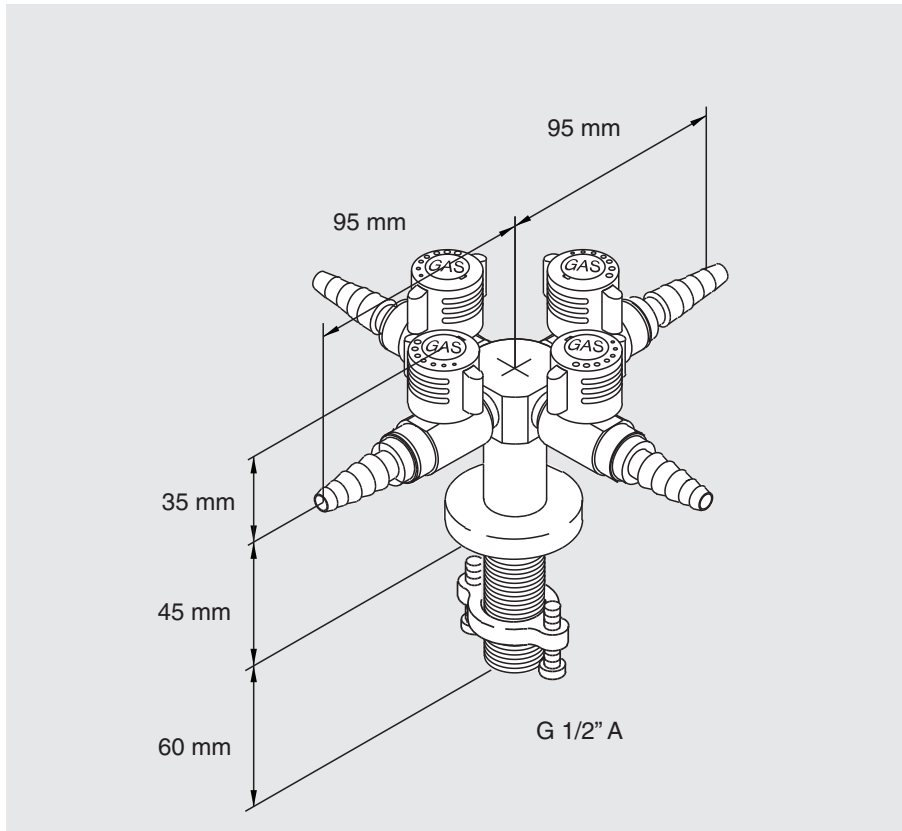

**BROEN school fittings for burning gases can be used for natural, town and low pressure bottle gases as well as vacuum and compressed air.**

The valves are designed to be used where a small and simple gas valve in large quantities is required.

BROEN school fittings have several safety features, including "lift/turn" safety handles and vandal resistant mounting accessories.

The fittings are surface treated with BROEN POLYCOAT powder coat, which is highly resistant to most chemicals, UV fading and heat.

**No. 08 320.989** Bench mounted school fitting with 4 valves and "lift/turn" safety handles.

Delivered with mounting accessories.

#### Materials with medium contact:

Metals:	Brass and nickel
Sealing:	Nitrile
Lubricant:	Approved for burning gas
Glue:	Loctite

Weight: 1.1 kg  
Maximum working pressure:  
7 bar/100 psi.

#### Mounting information:

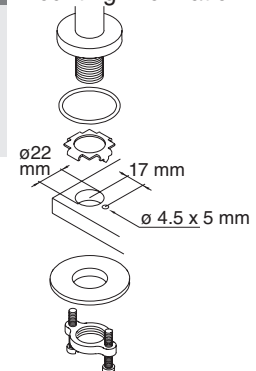

Drill  $\varnothing$  22 mm for the inlet.  
Drill  $\varnothing$  4.5 mm for the locking ring at a distance of 17 mm from the center of the  $\varnothing$  22 mm hole.  
The  $\varnothing$  4.5 mm hole must be at least 5 mm deep.

## BROEN school fittings - for burning gases

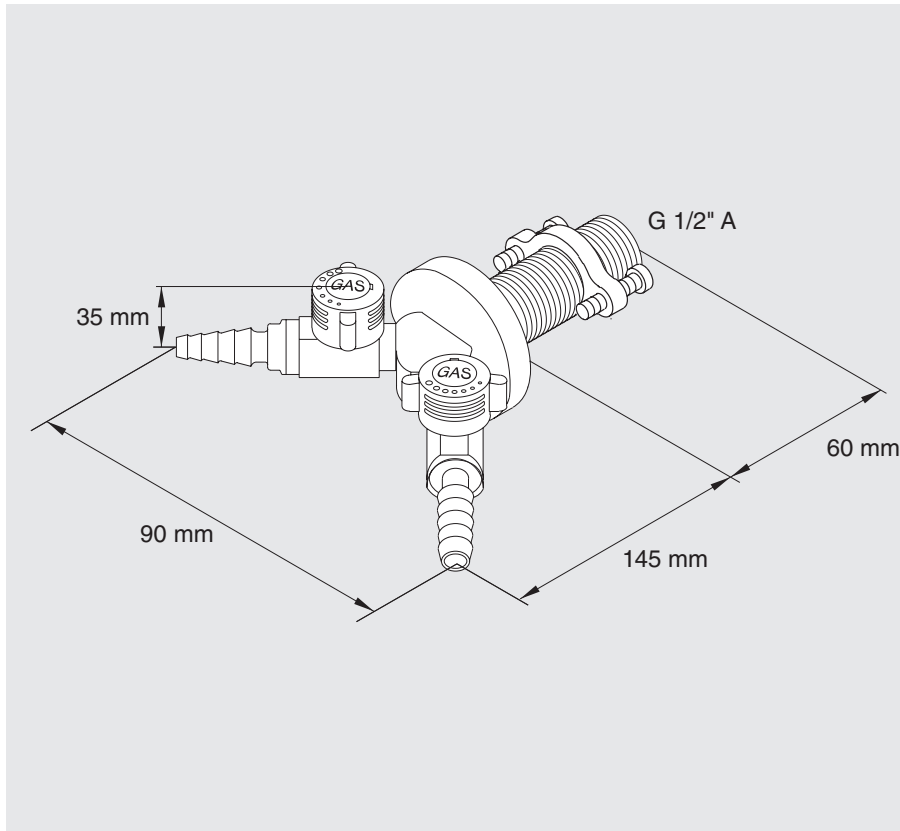

**BROEN school fittings for burning gases can be used for natural, town and low pressure bottle gases as well as vacuum and compressed air.**

The valves are designed to be used where a small and simple gas valve in large quantities is required.

BROEN school fittings have several safety features, including "lift/turn" safety handles and vandal resistant mounting accessories.

The fittings are surface treated with BROEN POLYCOAT powder coat, which is highly resistant to most chemicals, UV fading and heat.

**No. 08 116.989** Wall or suspended mounted school fitting with 2 valves (90°) with "lift/turn" safety handles.

Delivered with mounting accessories.

### Materials with medium contact:

Metals:	Brass and nickel
Sealing:	Nitrile
Lubricant:	Approved for burning gas
Glue:	Loctite

Weight: 1.2 kg

Maximum working pressure:  
7 bar/100 psi.

### Mounting information:

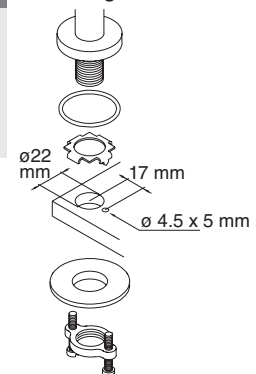

Drill  $\varnothing$  22 mm for the inlet.  
Drill  $\varnothing$  4.5 mm for the locking ring at a distance of 17 mm from the center of the  $\varnothing$  22 mm hole.  
The  $\varnothing$  4.5 mm hole must be at least 5 mm deep.

## BROEN school fittings - for burning gases

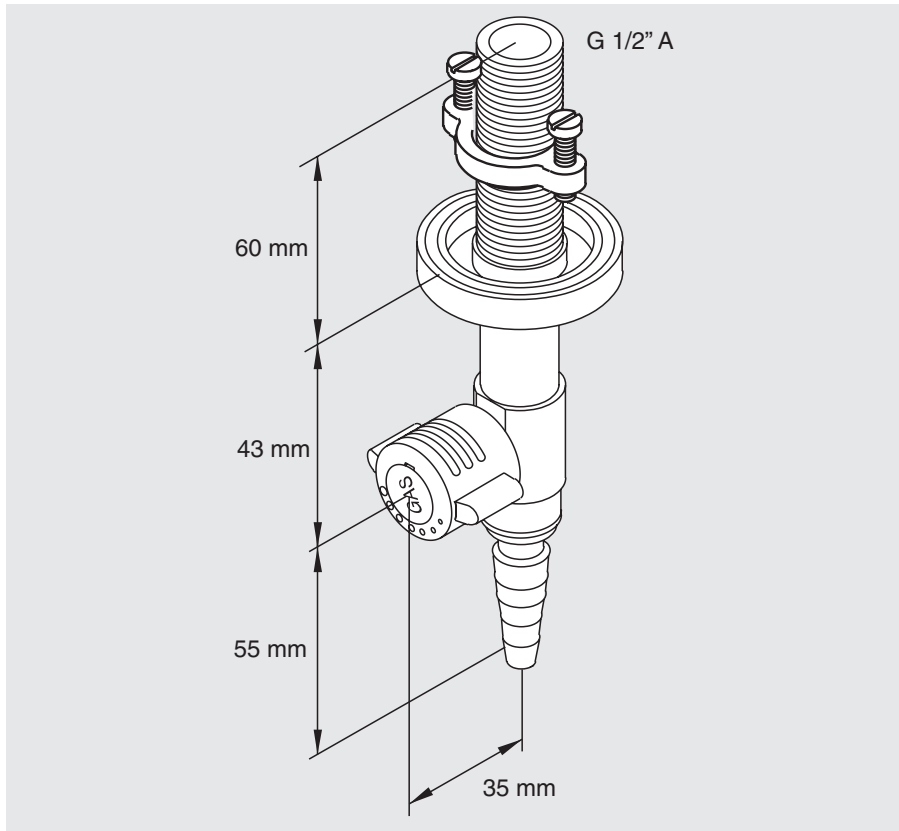

**BROEN school fittings for burning gases can be used for natural, town and low pressure bottle gases as well as vacuum and compressed air.**

The valves are designed to be used where a small and simple gas valve in large quantities is required.

BROEN school fittings have several safety features, including "lift/turn" safety handles and vandal resistant mounting accessories.

The fittings are surface treated with BROEN POLYCOAT powder coat, which is highly resistant to most chemicals, UV fading and heat.

**No. 08 722.989** Wall or suspended mounted school fitting with a "lift/turn" safety handle.

Delivered with mounting accessories.

### Materials with medium contact:

Metals:	Brass and nickel
Sealing:	Nitrile
Lubricant:	Approved for burning gas
Glue:	Loctite

Weight: 0.7 kg  
Maximum working pressure:  
7 bar/100 psi.

### Mounting information:

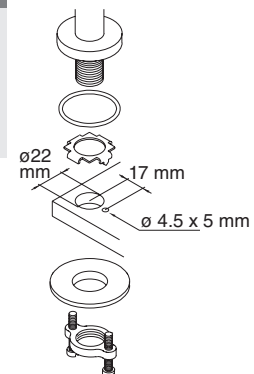

Drill ø 22 mm for the inlet.  
Drill ø 4.5 mm for the locking ring at a distance of 17 mm from the center of the ø 22 mm hole.  
The ø 4.5 mm hole must be at least 5 mm deep.

## BROEN school fittings

### - for burning gases

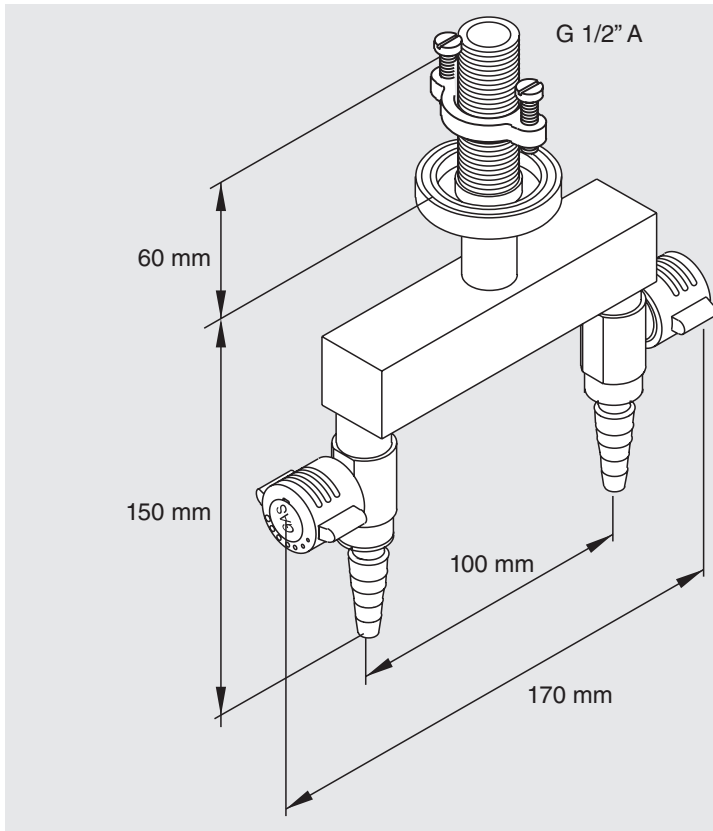

**BROEN school fittings for burning gases can be used for natural, town and low pressure bottle gases as well as vacuum and compressed air.**

The valves are designed to be used where a small and simple gas valve in large quantities is required.

BROEN school fittings have several safety features, including "lift/turn" safety handles and vandal resistant mounting accessories.

The fittings are surface treated with BROEN POLYCOAT powder coat, which is highly resistant to most chemicals, UV fading and heat.

**No. 08 321.989** Suspended school fitting with 2 valves and "lift/turn" safety handles.

Delivered with mounting accessories.

#### Materials with medium contact:

Metals:	Brass and nickel
Sealing:	Nitrile
Lubricant:	Approved for burning gas
Glue:	Loctite

Weight: 1.5 kg

Maximum working pressure:  
7 bar/100 psi.

#### Mounting information:

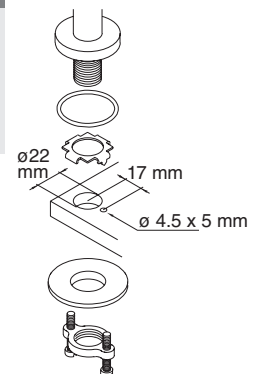

Drill  $\varnothing$  22 mm for the inlet. Drill  $\varnothing$  4.5 mm for the locking ring at a distance of 17 mm from the center of the  $\varnothing$  22 mm hole. The  $\varnothing$  4.5 mm hole must be at least 5 mm deep.